

Basic Instructions

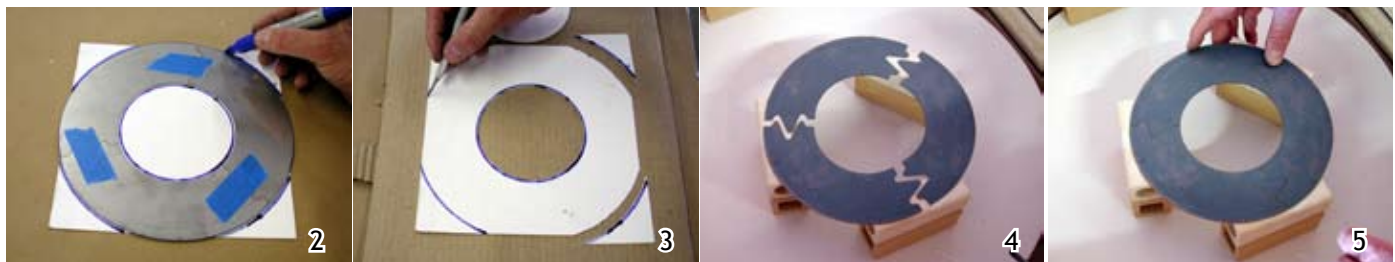

1) Select 3 kiln posts at least 4" long. They can be any height depending upon the desired depth of the finished piece of glass.
 2) Using an 8" x 8" square of 1/32" or thicker fiber paper as a release, tape the 3 parts of the Interlocking

Drop Ring together and mark the inner and outer circles with a felt pen. 3) Cut inside the felt pen line of the center circle. The fiber center needs to be slightly smaller than the metal ring center. Cut the outer circle inside the felt pen lines. 4) Center the seams of the metal pieces on the kiln posts.



5) Push the metal pieces together making sure that the kiln posts are not inside of the center. 6) Using the outside edges as a guide, center the fiber paper on the metal ring. 7) Center the first piece of glass on the ring. The glass can be any size from 8" diameter to 6" diameter. We used a 7" diameter for this project. 8) Sprinkle a light layer of fine frit around the edge of the glass to minimize bubbles being trapped between the layers. 9) Center the second layer of glass. 10) Sprinkle frit on the edge. 11) Center the top layer of glass. 12) Use a dry brush to sweep the excess frit away from the edge. 13) Fire to 1270° F for 1.5 hours. Add more time if needed.

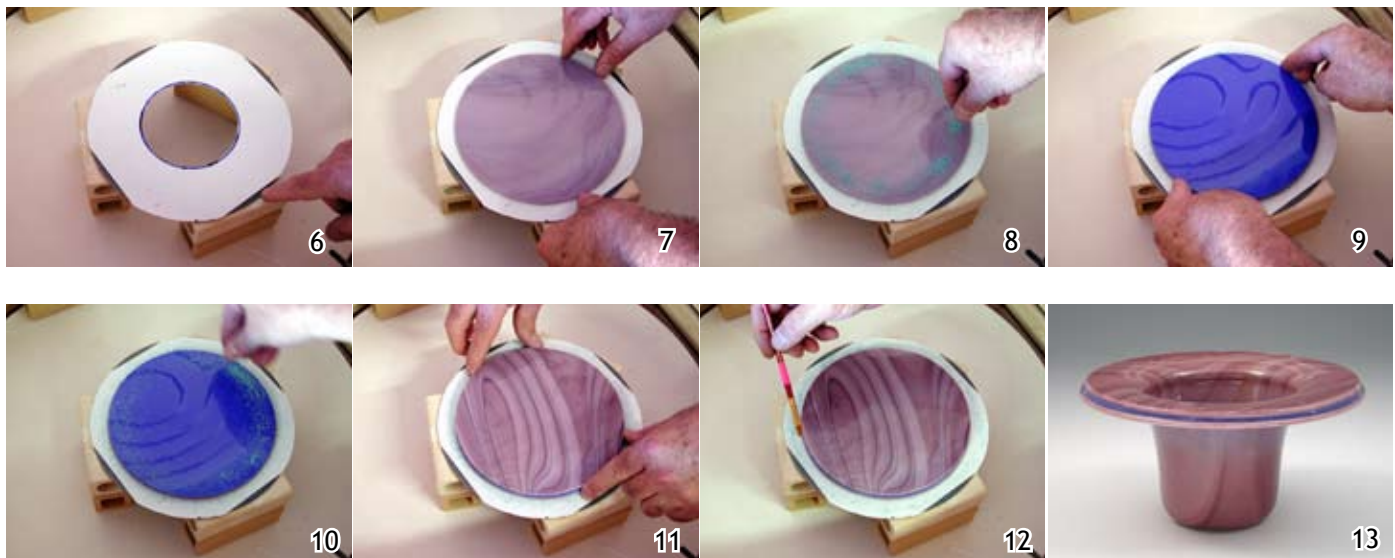

The Interlocking Drop Ring is made out of 18 gauge stainless steel.
 Outside Diameter - 8.43" Inside Diameter - 4.24"
 Designed by Fusion Headquarters, Fuse Master Products.